

E.P.NO.: 13804/1422/2022/W
T.L.P. No. 27 /2023/W

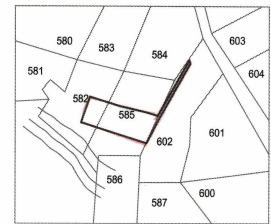

CAUTION:-
THIS LAYOUT IS LEGALLY VALID ONLY ON ITS RELEASE/ APPROVAL BY THE CONCERNED GRAMPANCHAYAT UNDER SECTION 113(b) TELANGANA PANCHAYAT RAJ ACT 2018 (Act no 5 / 2018) AS COMMENCED WIDE G.O.Ms.No.22 PR & RD Dt:18-04-2018 AND UNDER RULE 11 (3)(F) G.O.07 PR & RD, DT: 28-02-2002 ON FULLFILLMENT OF ALL LAYOUT CONDITIONS. ANY TRANSACTIONS PRIOR TO THE ABOVE IS ILLEGAL.

EXTRACT OF VILLAGE MAP



REFERENCE:
LAYOUT BOUNDARY: [Red line]
EXISTING ROADS: [Yellow line]
PROPOSED ROADS: [Pink line]
MORTGAGE AREA: [Hatched area]

AREA STATEMENT:

LAYOUT AREA	AC 7.625 CENTS.	36905.00 SQ.YDS.
SITE RESERVED FOR OPEN SPACE PARK (10%)	AC 0.763 CENTS.	3692.92 SQ.YDS.
ROADS AREA (37.08%)	AC 2.827 CENTS.	13682.68 SQ.YDS.
PLOTTED AREA (52.92%)	AC 4.035 CENTS.	19529.40 SQ.YDS.
MORTGAGE AREA (16.05%) ON PLOTTED AREA (FROM PLOT NO. 19, AND 22 TO 33)	AC 0.648 CENTS.	3136.32 SQ.YDS.
NO. OF PLOTS	64	

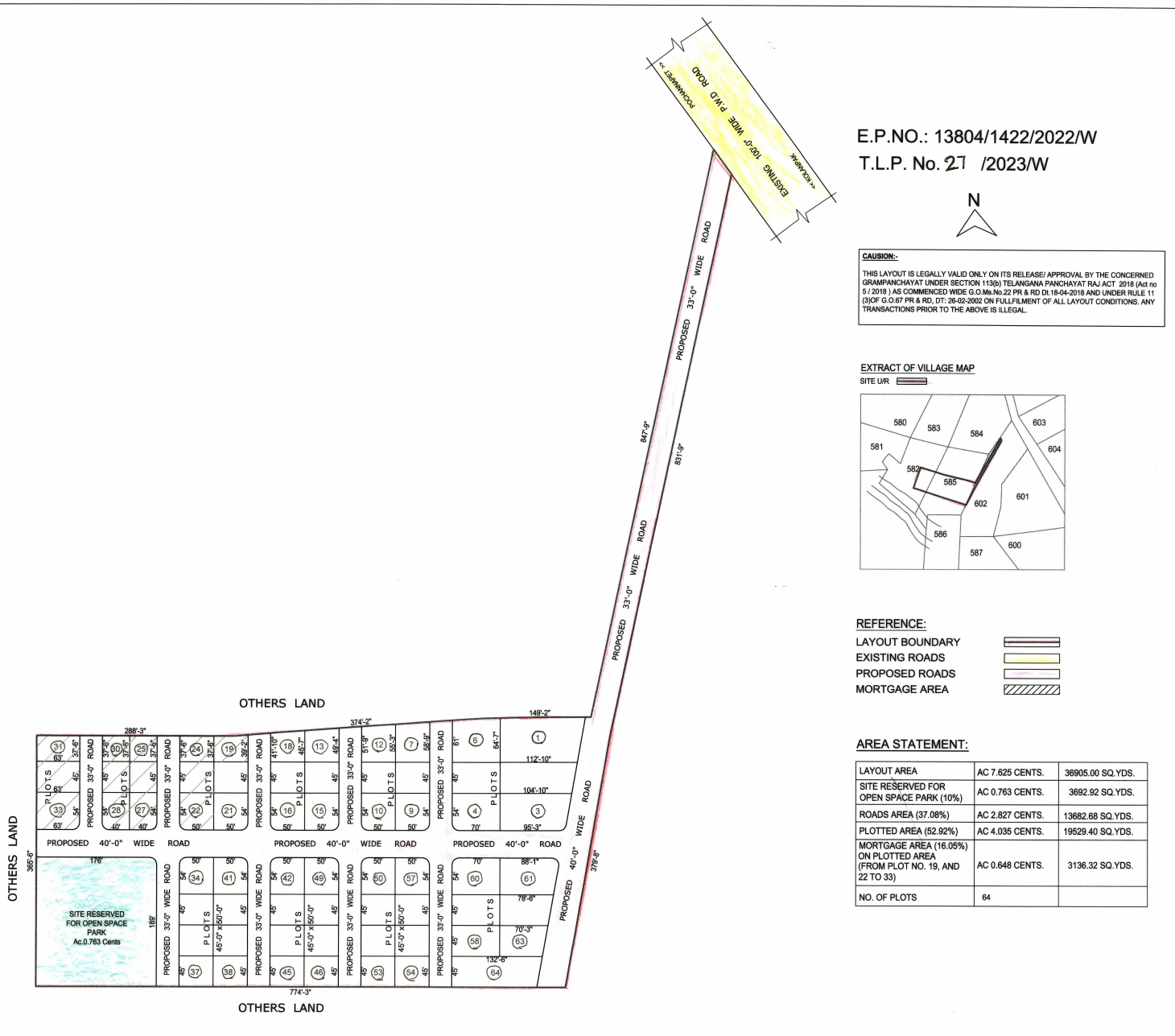

POCHANNAPET GRAM PANCHAYATH
DRAFT TECHNICAL LAYOUT PATTERN FROM RESIDENTIAL PLOTS IN SY.NOs.582/P, 585/P AND 602/P, STUATED AT POCHANNAPET (R.V), BACHANNAPET JANGAON DISTRICT.
SCALE :- 100 FEET TO AN INCH

S. Subrah 30/1/23 A.D.M.
R. Dhoti 30/1/23 T.P.A.
[Signature] 30/1/23 A.D.T.P.
[Signature] 01/2/2023 D.D.T.P.
[Signature] 01/2/23 JOINT DIRECTOR
B.Arch., M.U.R.P., A.I.T.P. 01/2/23 DIRECTOR OF TOWN & COUNTRY PLANNING GOVT. OF TELANGANA, HYDERABAD